

TECHNICAL DATA:

Nominal Flow Rate: 352 GPM / 80 cubic m/hr at 2m Headloss

Filter Area: 307 sq in / 1980 sq cm

Screen Size Available:

Micron	50	80	100	120	150	200	400	800
Mesh	250	200	150	120	100	80	40	20

Other Screens Available On Request

Max. Working Pressure: 232 psi / 16 bar

Min. Upstream Line Pressure Required During Rinse Cycle:
30 psi / 2.0 bar

Max. Working Temperature: 150°F / 65°C

Approximate Rinse Cycle Time : 5 ~ 7 sec.

Inlet & Outlet Connection: 4" DN100 Table E / ISO PN10 / ANSI CL150

Flush Drain Outlet Connection: 2" BSPT Female

Flush Drain Outlet May Be Rotated at 45° Intervals

Main Drain Header: DN50 2" Nominal Bore

Approximate Weight: Empty - 100 lb / 45 kg

Full of Water - 160 lb / 72 kg



TITLE
FW100HP GENERAL ASSEMBLY
 HP AUTOMATIC FILTER
 ***** NO CONTROLLER *****

SIZE A3	DWG. NO. GA-04485HP-N	REV. 0
------------	--------------------------	-----------

SCALE: 1:5.5 WEIGHT: SEE TECHNICAL DATA SHEET: 1 OF 1

PROPRIETARY AND CONFIDENTIAL
 THE INFORMATION CONTAINED IN THIS DRAWING IS THE SOLE PROPERTY OF FILTAWORX PTY. LTD. ANY REPRODUCTION IN PART OR AS A WHOLE WITHOUT THE WRITTEN PERMISSION OF FILTAWORX PTY. LTD. IS PROHIBITED.

MATERIAL
STAINLESS STEEL BODY
 AND COVERLID

FINISH

TOL. MACHINING	±0.25
TOL. ANGULAR	±0.25°

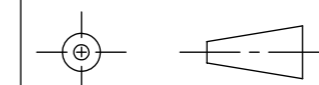

DIMENSIONS ARE IN [inches]/millimeter

REV.	DESCRIPTION	DATE	DRAWN	APPROVE
0	INITIAL RELEASE	19/05/2023	JD	MB
REVISIONS				