

TECHNICAL DATA:

Nominal Flow Rate: 110 GPM / 25 cubic m/hr at 2m Headloss

Filter Area: 189 sq in / 1220 sq cm
 Screen Size Available:

Micron	50	80	100	120	150	200	400	800
Mesh	250	200	150	120	100	80	40	20

Other Screens Available On Request

Max. Working Pressure: 232 psi / 16 bar
 Min. Upstream Line Pressure Required During Rinse Cycle: 30 psi / 2.0 bar

Max. Working Temperature: 150°F / 65°C

Approximate Rinse Cycle Time : 5 ~ 7 sec.

Inlet & Outlet Connection: 2" DN50 Table E / ISO PN10 / ANSI CL150
 Flush Drain Outlet Connection: 2" BSPT Male with O-Ring
 Flush Drain Outlet May Be Rotated at 45° Intervals
 Main Drain Header: 2" Nominal Bore

Approximate Weight: Empty - 81.6 lb / 37 kg
 Full of Water - 125.7 lb / 57 kg



TITLE
**FW050HP GENERAL ASSEMBLY
 HP AUTOMATIC FILTER**
 -----NO CONTROLLER-----

SIZE	DWG. NO.	REV.
A3	GA-04280HP-N	0

SCALE: 1:5.5 WEIGHT: SEE TECHNICAL DATA SHEET: 1 OF 1

PROPRIETARY AND CONFIDENTIAL
 THE INFORMATION CONTAINED IN THIS DRAWING IS THE SOLE PROPERTY OF FILTAWORX PTY. LTD. ANY REPRODUCTION IN PART OR AS A WHOLE WITHOUT THE WRITTEN PERMISSION OF FILTAWORX PTY. LTD. IS PROHIBITED.

MATERIAL
**STAINLESS STEEL BODY
 AND COVER LID**

TOL. MACHINING	±0.25
TOL. ANGULAR	±0.25°

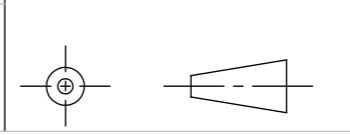

0	INITIAL RELEASE	19/05/2023	JD	MB
REV.	DESCRIPTION	DATE	DRAWN	APPROVE
REVISIONS				

DIMENSIONS ARE IN [inches]/millimeter